

SuperFlex®

PUNCTUM PLUG

The Comprehensive Solution for Dry Eye

EagleVision has reinvented the punctum plug with additional features.

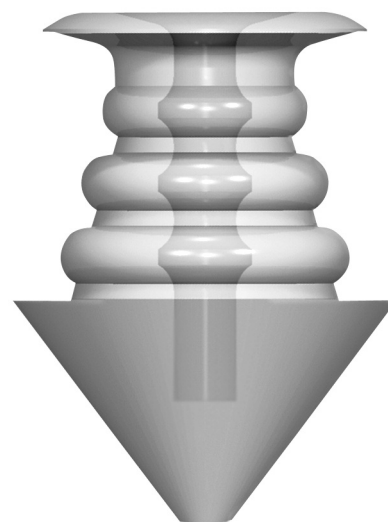

| DESCRIPTION | SIZE | REF |
|---|-------------------------|-------|
| Supplied: 2 sterile pre-loaded punctum plugs on disposable inserter/dilators. | 0.3mm dia. x 1.1mm long | 31732 |
| | 0.4mm dia. x 1.1mm long | 31742 |
| | 0.5mm dia. x 1.2mm long | 31752 |
| | 0.6mm dia. x 1.3mm long | 31762 |
| | 0.7mm dia. x 1.4mm long | 31772 |
| | 0.8mm dia. x 1.5mm long | 31782 |
| | 0.9mm dia. x 1.7mm long | 31792 |
| | 1.0mm dia. x 1.8mm long | 31702 |
| | 1.1mm dia. x 2.0mm long | 31712 |
| 1.2mm dia. x 2.0mm long | 31722 | |
| 1.3mm dia. x 2.0mm long | 31802 | |

U.S. Patent Nos. 6,016,806 & 6,027,470 & 6,041,785 & 6,082,362.

CE Marked

- **Better fit**
- **Easier insertion**
- **Greater patient comfort**

 EagleVision®